



Avian Adventures

INSTRUCTIONS FOR ASSEMBLY OF DOUBLE VISTA



Unwrap and remove all parts from each box. Keep the box(es) and packing material until the cage is assembled. In case of return or exchange failure to return product in similar condition as received could result in limited reimbursement. Check to ensure you have all the following parts:

- TOP GRATE
- 2 FRONT PANELS (WITH DOOR)
- 2 BACK PANELS (24" WIDE)
- 4 SIDE PANELS (20" WIDE)
- 2 PERCHES
- 4 CUP HOLDERS AND CUPS
- 3 REMOVABLE GRATES
- 2 REMOVABLE TRAYS (1 DEEPER)
- MAIN BASE
- 4 CASTERS
- BOTTLE OF TOUCH UP PAINT

Cage Assembly (see attached numbered diagram):

1. Place the MAIN BASE upside down and insert CASTERS into the legs (they can be installed using a rubber mallet). Turn the MAIN BASE onto its casters.
2. Locate the bottom FRONT PANEL – it is shorter than the other front panel – and insert pegs into the holes in the front of the BASE.
3. Locate the bottom BACK PANEL – it is shorter than the other back panel – and insert pegs into the holes in the back of the BASE.
4. Locate the bottom SIDE PANELS – also shorter than the other side panels – and slide over the metal sleeve at the bottom of the FRONT and BACK PANELS. Spread the front and back panels out at the top to insert their tabs into the matching sleeves on the side panels.
5. Insert the second set of FRONT and BACK panels on top of the first.
6. Insert the second set of SIDE PANELS.
7. Insert the pegs attached to the TOP GRATE into the holes on the top of the PANELS to hold all PANELS together.
8. Slide a REMOVABLE GRATE in immediately below each of the main doors. Note: Each cage can be used without the grate by inserting the tray into the grate track.
9. Slide a TRAY in immediately below the grates. Use the deeper tray for the bottom cage.
10. For the bottom cage slide a REMOVABLE GRATE in the track immediately ABOVE the front panel. This forms the top of the cage (removable for easy cleaning).
11. Install the PERCHES on the inside of the cages. The notches fit over the cage bars on each side.
12. With the feed doors open, insert the CUP HOLDERS into the tubes on the inside of the doors.
13. Insert a CUP into each of the CUP HOLDERS.
14. To install each LATCH, first remove the knob by unthreading it. Ensure the spring is placed over the round end of latch. Insert the assembly into the lock sleeve mounted onto the cage door so that the round end protrudes through the opposite end. Position the assembly so that the threaded hole is visible through the front of the latch and screw the knob through the lock sleeve into the threaded hole on the latch. Turn counter-clockwise to loosen and open the door. When securing the door, tighten in the opposite direction to go in to the "lock" position.

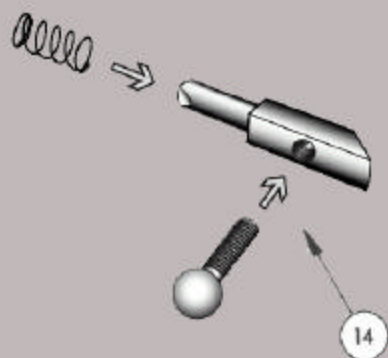
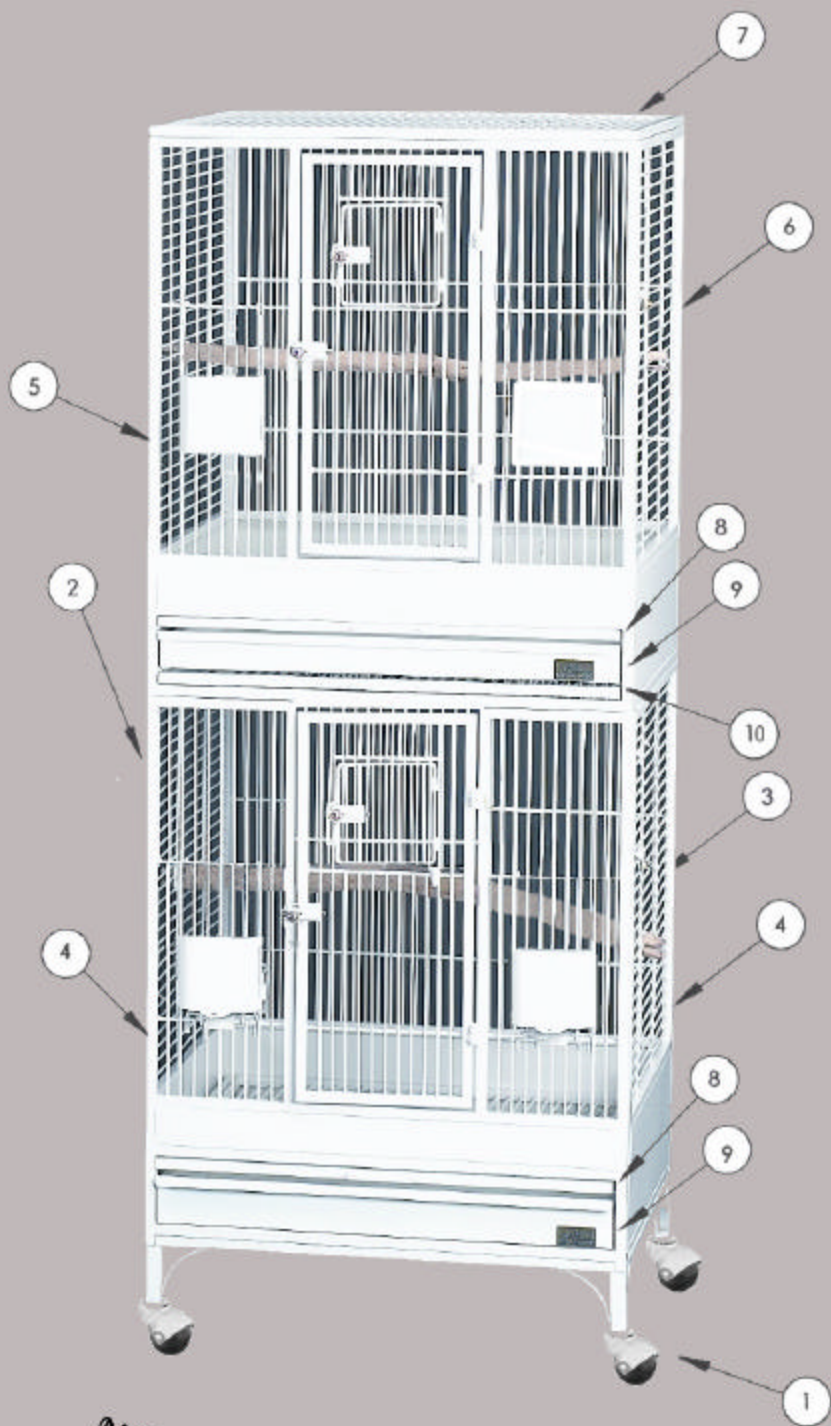

Avian Adventures