



Avian Adventures

INSTRUCTIONS FOR ASSEMBLY OF GRANDE PLAYTOP



Unwrap and remove all parts from each box. Keep the boxes and packing material until the cage is assembled. In case of return or exchange failure to return product in similar condition as received could result in limited reimbursement. Check to ensure you have all the following parts:

Cage Parts

- TOP GRATE
- FRONT PANEL (WITH DOOR)
- BACK PANEL
- 2 SIDE PANELS (WITH FOOD DOORS)
- “X” FRAME
- 4 SKIRTS (2 LONG, 2 SHORT)
- PERCH
- 3 CUP HOLDERS AND CUPS
- BOTTOM GRATE
- BOTTOM TRAY
- 4 CASTERS

Playpen Parts

- PLAYPEN BASE
- PLAYPEN TRAY
- PLAYPEN CROSSBAR PERCH
- 4 LADDERS
- BARREL BOLTS
- 2 CUPS
- 2 TOY HOOKS
- 4 DECORATIVE BALLS
- BOTTLE OF TOUCH UP PAINT

Cage Assembly (see attached numbered diagram. NOTE: This is a TWO person task):

1. Turn the FRONT PANEL and BACK PANEL upside down and insert the CASTERS into the legs (they can be installed using a rubber mallet on the metal stem, NOT on the rubber wheel).
2. Have one person hold the FRONT PANEL upright and stand on the inside (door swings away).
3. Have them also hold the BACK PANEL upright, parallel with the front and approximately 30” apart. There are tabs on the lower part of each panel, these should be on the inside.
4. Have the other person slide the SIDE PANELS over the metal sleeve at the bottom of the FRONT and BACK PANELS and push them into the slots at the top.
5. Insert the pegs attached to the TOP GRATE into the holes on the top of the PANELS to hold all PANELS together.
6. The “X” frame (not pictured) is installed at the bottom of the cage just above the wheels.
7. If desired, slide the bottom grate into the track just below the front door.
8. The BOTTOM TRAY can go in two positions: 1) If you do not want to use the grate, you may slide the tray into the track just below the front door; or 2) Position the tray just above the front crossbar, and ensure the tray edge is inside the track on each side of the cage.
9. Locate the pair of SEED GUARDS with PEGS and insert the pegs into the metal sleeves attached to the lower part of the cage.
10. Then nest the SEED GUARDS with flat TABS into the ones already on the cage.
11. Install the PERCH on the inside of the cage. The notches fit over the cage bars on each side.
12. With the feed doors open, insert the CUP HOLDERS into the tubes on the inside of the doors.
13. Insert a CUP into each of the CUP HOLDERS.
14. To install each LATCH, first remove the knob by unthreading it. Ensure the spring is placed over the round end of latch. Insert the assembly into the lock sleeve mounted onto the cage door so that the round end protrudes through the opposite end. Position the assembly so that the threaded hole is visible through the front of the latch and screw the knob through the lock sleeve into the threaded hole on the latch. Turn counter-clockwise to loosen and open the door. When securing the door, tighten in the opposite direction to go in to the “lock” position.

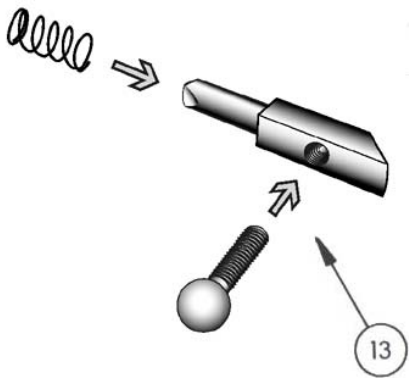
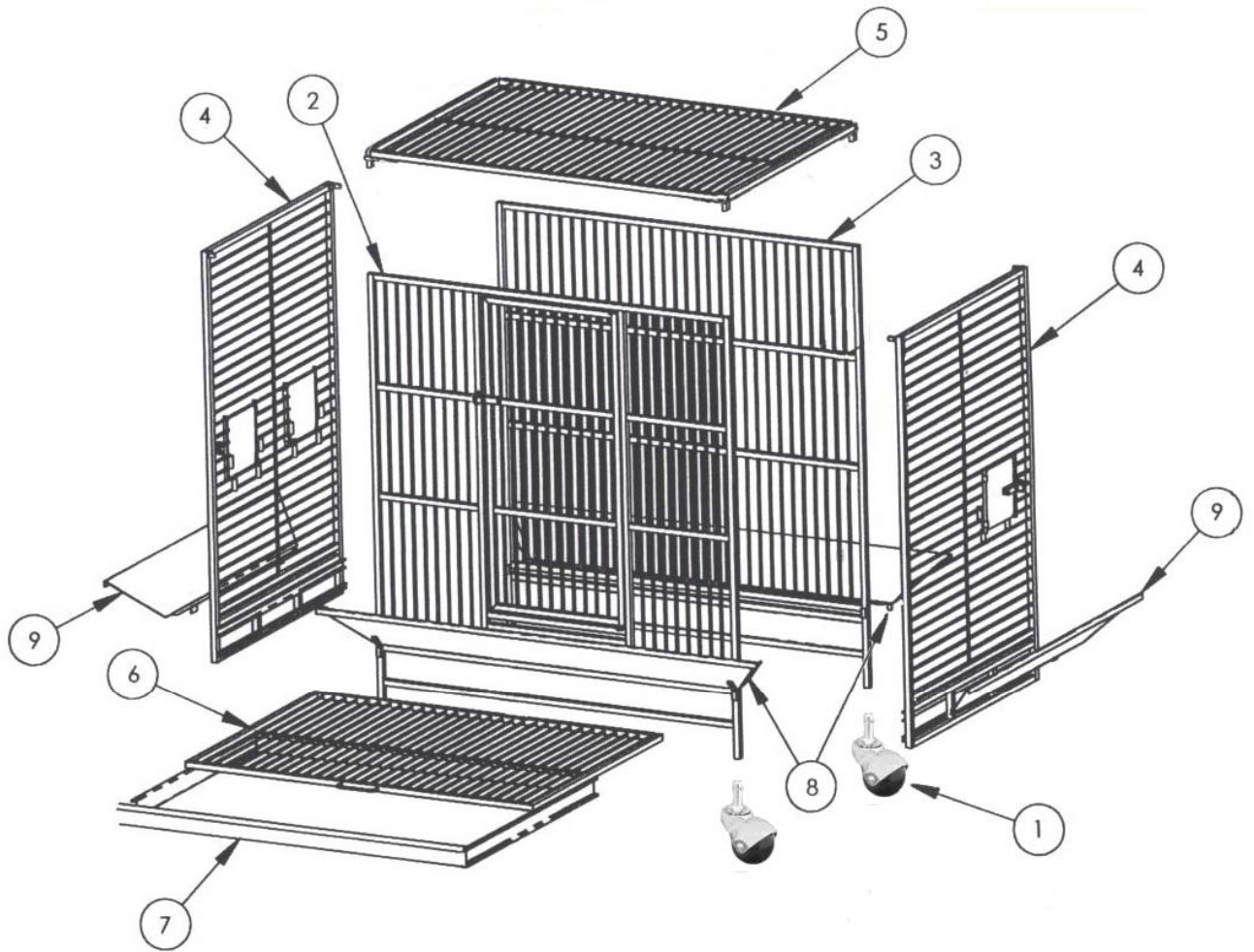

Please see our web site at <http://www.avianadventures.com> for a detailed video demonstration of how to assemble a similar cage.

Playpen Assembly:

15. First attach all the LADDERS to the PLAYPEN BASE and snug the screws, allowing a little bit of play so the LADDER can shift a bit. This is best accomplished by inserting the BARREL BOLTS from the bottom with the PLAYTOP TRAY removed. Lean the LADDER on one hand while holding the BARREL BOLT in place with the same hand, Use the other hand to thread the screw. Note that the barrel should not come all the way through the LADDER. If it did, it would prevent the LADDER from being drawn tight against the PLAYTOP BASE. There may be plastic washers to use to adjust the fit, if needed.
16. Insert the PLAYPEN CROSSBAR PERCH between the LADDERS, making sure the food cup holders face toward the front (where the TRAY slides in). Use a small screwdriver, nail, chopstick or similar thin item to align one set of opposing ladders and perch, pushing it well through the holes. This should support one side of the PERCH.
17. Insert a BARREL BOLT through the other LADDER, the PERCH and line up with the opposite LADDER. Thread the screw carefully, they can be cross-threaded, and make snug, but not tight.
18. Insert the rest of the BARREL BOLTS and once all have been inserted, tighten, using care not to over-tighten. They don't require a lot of force to make the playpen secure.
19. Insert TOY HOOKS into the open square tubes.
20. Screw decorative balls into threaded holes on corners of the PLAYPEN FRAME.
21. Nest the assembled PLAYPEN inside the top grate on the cage, or use off of the cage as/when desired. When on the cage, we recommend removing the TRAY to allow more light into the cage.

