



Avian Adventures

INSTRUCTIONS FOR ASSEMBLY OF GRANDE DOMETOP



Unwrap and remove all parts from each box. Keep the boxes and packing material until the cage is assembled. In case of return or exchange failure to return product in similar condition as received could result in limited reimbursement. Check to ensure you have all the following parts:

- DOME TOP
- 1 FRONT PANEL (WITH DOOR)
- 1 BACK PANEL
- 2 SIDE PANELS (WITH FOOD DOORS)
- “X” FRAME
- 4 SKIRTS (2 LONG, 2 SHORT)
- PERCH
- 3 CUP HOLDERS AND CUPS
- BOTTOM GRATE
- BOTTOM TRAY
- 4 CASTERS
- BOTTLE OF TOUCH UP PAINT

Cage Assembly (see attached numbered diagram. NOTE: This is a TWO person task):

1. Turn the FRONT PANEL and BACK PANEL upside down and insert the CASTERS into the legs (they can be installed using a rubber mallet on the metal stem, NOT on the rubber wheel).
2. Have one person inside the cage and hold the FRONT PANEL (2 on the diagram) and BACK Have one person hold the FRONT PANEL upright and stand on the inside (door swings away).
3. Have them also hold the BACK PANEL upright, parallel with the front and approximately 30” apart. There are tabs on the lower part of each panel, these should be on the inside.
4. Have the other person slide the SIDE PANELS over the metal sleeve at the bottom of the FRONT and BACK PANELS and push them into the slots at the top.
5. The “X” frame (not pictured) is installed at the bottom of the cage just above the wheels.
6. Insert the pegs attached to the DOMETOP into the holes on the top of the PANELS to hold all PANELS together.
7. If desired, slide the bottom grate into the track just below the front door.
8. The BOTTOM TRAY can go in two positions: 1) If you do not want to use the grate, you may slide the tray into the track just below the front door; or 2) Position the tray just above the front crossbar, and ensure the tray edge is inside the track on each side of the cage.
9. Locate the pair of SEED GUARDS with PEGS and insert the pegs into the metal sleeves attached to the lower part of the cage.
10. Then nest the SEED GUARDS with flat TABS into the ones already on the cage.
11. Install the PERCH on the inside of the cage. The notches fit over the cage bars on each side.
12. With the feed doors open, insert the CUP HOLDERS into the tubes on the inside of the doors.
13. Insert a CUP into each of the CUP HOLDERS.
14. To install each LATCH, first remove the knob by unthreading it. Ensure the spring is placed over the round end of latch. Insert the assembly into the lock sleeve mounted onto the cage door so that the round end protrudes through the opposite end. Position the assembly so that the threaded hole is visible through the front of the latch and screw the knob through the lock sleeve into the threaded hole on the latch. Turn counter-clockwise to loosen and open the door. When securing the door, tighten in the opposite direction to go in to the “lock” position.

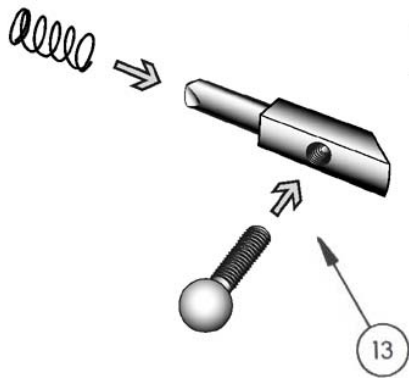
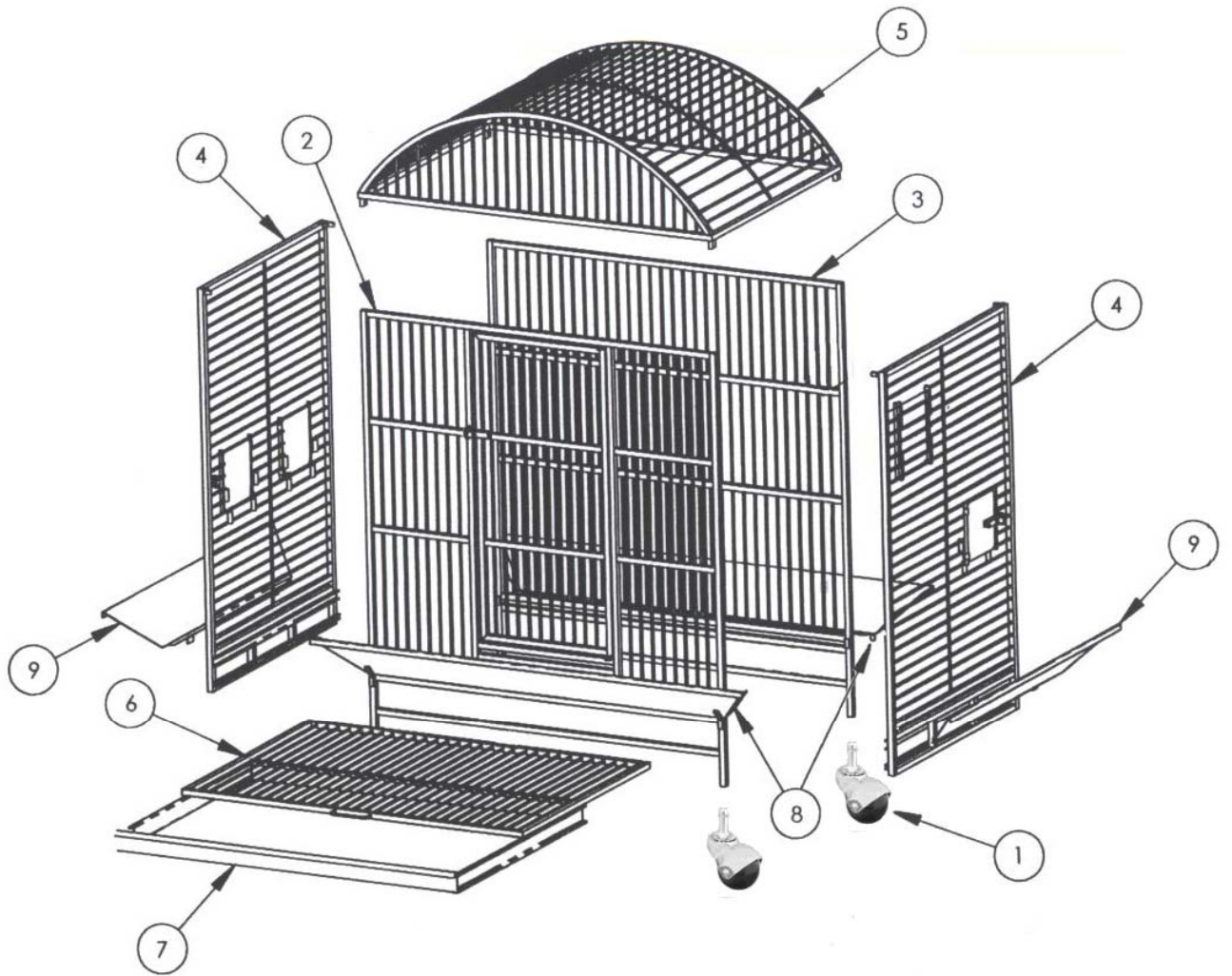

Please see our web site at <http://www.avianadventures.com> for a detailed video demonstration of how to assemble a similar cage.